

BreathScan®

ALCOHOL DETECTOR

INSTRUCTIONS



1. Wait 15 minutes after last alcoholic drink (alcohol takes about 15 minutes to have an effect on your system) OR drink a glass of water before taking the test.

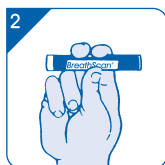

2. Squeeze middle of the outer plastic tube between thumb and forefinger to break inner glass ampule containing yellow crystals SQUEEZE ONLY ONCE. DO NOT CRUSH OR BEND TUBE. Use tester immediately

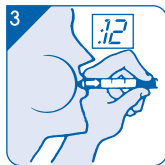

3. Take a deep breath and blow, in one continuous breath, for 12 seconds through the end of the tube designated by arrow. BLOW VERY HARD. EXHALE THROUGH THE TUBE, DO NOT INHALE. Shake tester to distribute crystals evenly, wait two minutes. Identify color change of majority of crystals.

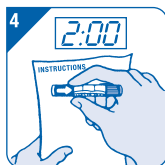

4. Testers will develop an aqua (blueish green/greenish blue) cast at levels at or above the level designated by the tester. For best results, compare to unused tester.

BREATHSCAN® Alcohol detector is available in several configurations. Check your *BreathScan®* tester for its configuration. It is indicated by a specific fraction of a percentage point such as .02%, .04% etc. on the left side of the tester. Check the legal limit for intoxication in your state.

Note: Accuracy of test results may not be reliable if test is not conducted according to instructions.

Refrain from driving after drinking. Do not drive at all if any crystals change color.

FOR ADDITIONAL INFORMATION AND WARNING SEE BACK OF THIS PAMPHLET.



BreathScan®

ALCOHOL DETECTOR

BreathScan® brand detector is a disposable breath alcohol indicator designed for one-time use. The BreathScan® detector contains indicator chemistry which will undergo a color change in the presence of alcohol contained in the breath of the subject. This product provides a reliable indication of alcohol present in the exhaled breath of the test subject when the instructions for use of the BreathScan® indicator are rigidly followed. The manufacturers, suppliers, agents, distributors and retailers make no warranty, expressed or implied, as to the ability of this device to determine or detect intoxication of the subject or to accurately indicate the subject's blood alcohol level. Decisions and/or actions based on the use of this product by any person shall be at such person's own risk. The manufacturers, suppliers, agents, distributors and retailers assume no responsibility for consequences of subjects who test negative using this device but who later show that they are under the influence of or their judgment has been impaired by alcohol.

WARNING: This product should be used only as a screening device and is only an indication of the possible presence of alcohol in the blood of the test subject. Correlation between breath alcohol content and blood alcohol content depends on many variables, including altitude. The exact concentration of alcohol in the blood of the test subject

cannot be accurately determined by using this device.

This device is not intended to legally determine blood alcohol presence or level. No inference of intoxication is to be made from a positive indication. *BreathScan®* is guaranteed to be free from manufacturer's defects. This warranty is expressly made in lieu of any and all other warranties expressed or implied including the warranties of merchantability and fitness for a particular purpose or use. There are no warranties expressed beyond the description of the product contained on this package. The warrantor expressly disclaims liability for incidental, special, or consequential damages of any nature.

Use immediately after breaking glass vessel. Do not use if glass vessel containing crystals is ruptured prematurely or if crystals are not yellow.

Store at room temperature.

Keep out of reach of children.
Do not immerse in liquid.

DO NOT INGEST.

If ingested, induce vomiting and contact your physician.

BreathScan® is a registered trademark of
WNCK, Inc.

Patented under U.S.
Patent #4, 740, 475
MADE IN U.S.A.

MATERIAL SAFETY DATA SHEET

I Manufacturer:

WNCK, Inc.
P.O. Box 130369
The Woodlands, TX 77393-0369
281-419-2500

II. Product:

BreathScan® Disposable Alcohol Detector

Capsule Contents:

Synthetic Amorphous Silica (SiO₂xH₂O) 97.96% or more
Sulfuric Acid (H₂SO₄) 27.0% or less
Potassium Dichromate (K₂Cr₂O₇) 0.65% or less

III. Physical Data: Shell glass ampoule containing yellow granules, encased in PETG tube closed on both ends by PETG porous filters

Chemical Data:

Ampoule contents react with alcohol

IV-VI Hazards / Routes of Entry / Exposure Limits: The chemical, toxicological and physical properties of these products have not been determined. The levels of Sulfuric Acid and Potassium Dichromate in the test unit may be well below the threshold level required to precipitate the response shown for the parent material.

The amount of hexavalent chromium present in each tube prior to breath alcohol testing is very small (<10⁻⁶)

VII-IX Safe Handling Procedures / Control Measures / Emergency First Aid

The amount of hexavalent chromium present in each tube prior to breath alcohol testing is very small (<10⁻⁶)
Normal use is non-hazardous. Misuse that will allow contact with broken glass ampoules and its contents may be hazardous.

Inhalation: Exposure to dust may cause nasal irritation, lung irritation, coughing, labored breathing, wheezing and chest pain. If dust is generated, wear NIOSH/MSDS approved respirator chosen based on exposure level. In case of exposure, remove to fresh air.

Eye Contact: Contents are corrosive and broken ampoules, will create glass splinters. Direct contact may cause severe damage. Safety glasses should be worn when handling raw material. In case of exposure, immediately wash from eyes with large amounts of water, occasionally lifting upper and lower eyelids. Get medical attention immediately.

Skin Contact: Gloves should be worn when handling raw material. In case of exposure, wash with soap and water.

Ingestion: May cause severe burning in mouth, throat and abdomen. If ingested, give milk and water for dilution. Vomiting should be induced after fluids are given. Get prompt medical attention.

Date this document was prepared:
September 21, 1995

Signature: _____
Title: President/CEO